



Rakes

3-point linkage
With follow-up device



Feature

- 1 Swath is placed on the right side
- 2 Adjustable transversal inclination of the rotor (not applicable for TS 301 DN)
- 3 Wide-track chassis
- 4 All tine supports can be removed
- 5 The removed tine supports are stored in horizontal position at the machine
- 6 The swath cloth can be continuously adjusted
- 7 D-shaped circular tube frame
- 8 Forged, flexible lower control arms

Benefit

- Better ergonomic position for the driver since the operating elements of modern tractors are always on the right side
- Optimum raking
- Optimum adjustment to the ground
- Very good suitability on slopes
- Small transport and parking width
- Better ergonomic working
- No risk of accidents
- The swath width can be adjusted in accordance with your requirements
- High stability
- Very good suitability on slopes
- Optimum adjustment to the ground

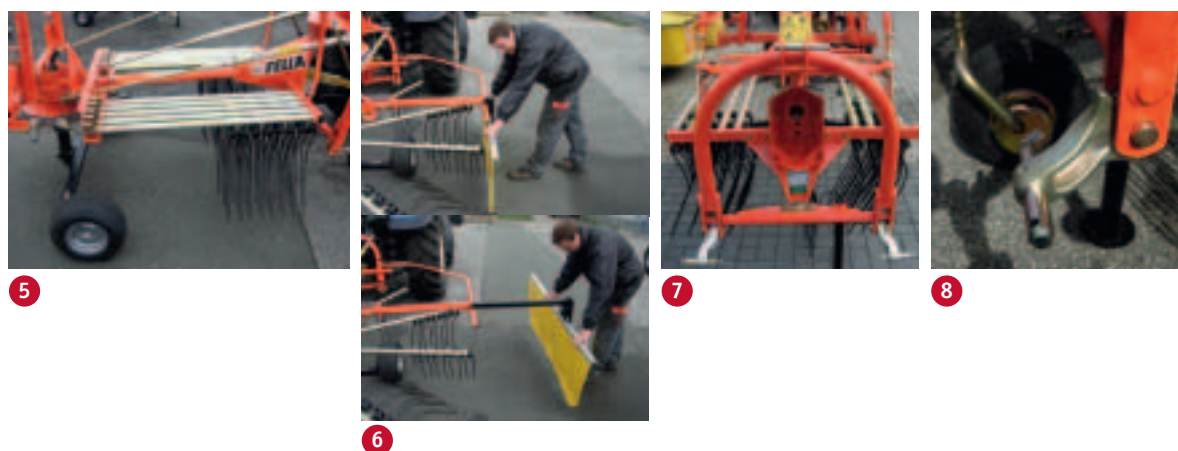
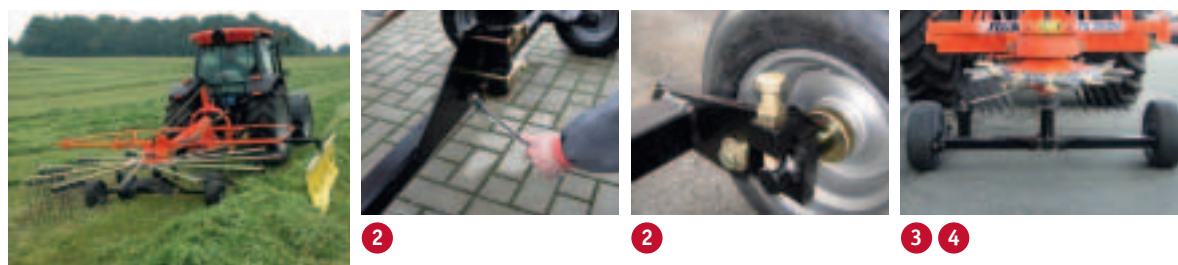

Denomination of machine	TS 301 DN	TS 351 DN	TS 391 DN
Reference number	716 213 0000	716 222 0000	716 227 0000
Mounting Category	I+II		
Working width approx. m	3,40	3,60	3,80
Swath width approx. m	0,60 - 1,30		
Transport width approx. m	1,42	1,55	
Transport length approx. m	2,00	2,21	2,31
Tine arms per rotor	8	10	
Double tines per arm	3		4
Tires of rotor chassis	2 x 15/6.00-6	2 x 16/6.50-8	
Power demand approx. kW/hp	17/23	20/27	
Necessary hydraulic outlets	-		
PTO rpm	540		
PTO-shaft	overload safety clutch (radial pin clutch)		
Warning panels	optional		
Electrical lightning	optional		
Weight approx. kgs	360	420	440
Assembling time h	1,0		

Special equipment	reference no.	
Warning plates	716 778 0000	
Electric lighting, (to be mounted on warning plates 716 778 0000 only)	716 779 0000	
Contact wheel 15/6.00-6 (low-pressure tires), for optimum adjustment to the ground	715 572 0000	
1 set of tandem axle with wheel 15/6.00-6 (low-pressure tires), for a smooth run and clean work at all conditions and for all types of forage, for TS 301 DN	716 762 0000	
1 set of tandem axles with wheel 16/6.50-8 (super ballon tires), for a smooth run and clean work at all conditions and for all types of forage, for TS 351/391 DN	716 765 0000	
PTO shaft with overrunning clutch, included in the delivery	716 730 0000	
PTO shaft with overrunning clutch, additional delivery	716 733 0000	
Spare wheel 15/6.00-6 with support, for TS 301 DN	715 587 0000	
Spare wheel 16/6.50-8 10PR (super ballon tires) with support, for TS 351/391 DN	716 828 0000	