

**BOMAG OSZILLATION
BW 161 ADO - 50, BW 202 ADO - 50**

PERFORMANCE DATA



Machine type	Compaction output (m ³ /h) at recommended soil layer thicknesses		
	Gravel, sand	Mixed soil	Silt, clay
BW 161 ADO - 50	150-320	140-260	100-220
BW 202 ADO - 50	280-550	200-400	150-250

Machine type	Compaction output (t/h) at different asphalt layer thicknesses		
	2-4 cm	6-8 cm	10-14 cm
BW 161 ADO - 50	50-100	100-200	150-230
BW 202 ADO - 50	80-160	130-270	200-340

Technical Data

Shipping dimensions in m3	without ROPS	with ROPS
BW 161 ADO - 50	20,572	27,103
BW 202 ADO - 50	25,670	33,820

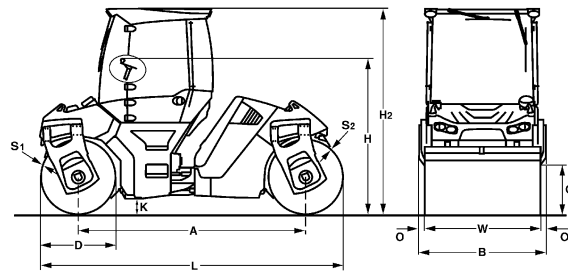

Standard Equipment

- Front drum vibration: 2 amplitudes / 2 frequencies
- TanGO Rear drum Oscillation: 1 Amplitude/ 1 Frequency
- Highly wear resistant oscillation drum
- Autom. vibration operation
- Individual vibration control
- Driver's seat, slewable
- laterally slidable with steering wheel
- V-belt protection
- Pressure sprinkling system with 2 pumps
- Back-up alarm
- Battery disconnect switch
- Folding scrapers

Optional Equipment

- ROPS cabin with seat belts + heating, Ventilation + 4 Working head lights
- Crab-walk to both sides (170mm)
- ROPS cabin with air conditioning
- Rotary beacon
- 2 LED-lights for cabin roof (flatbeam)
- ROPS/FOPS
- Asphalt temperature display
- BOMAG TELEMATIC START
- Compartments for documents and tools
- Outside mirrors
- Working lights
- Lights with german regulations
- Frequency 70Hz

Dimensions in mm

	A	B	C	D	H	H2	K	L	O	S1	S2	W
BW 161 ADO - 50	3620	1836	670	1220	2315	3050	250	4840	78	17	13	1680
BW 202 ADO - 50	3620	2291	670	1220	2315	3050	250	4840	78	19	13	2135

Technical Data

Weights

	BOMAG BW 161 ADO - 50	BOMAG BW 202 ADO - 50
Operating weight CECE w. cab.	kg 9.500	11.550
Axle load, front CECE	kg 5.100	6.350
Axle load, rear CECE	kg 4.300	5.200
Static linear load, front CECE	kg/cm 30,4	29,7
Static linear load, rear CECE	kg/cm 25,6	24,4
Grossweight	kg 10.500	12.500

Dimensions

	BOMAG BW 161 ADO - 50	BOMAG BW 202 ADO - 50
Track radius, inner	mm 4.900	4.673

Driving Characteristics

	BOMAG BW 161 ADO - 50	BOMAG BW 202 ADO - 50
Max. travel speed	km/h 0- 12,0	0- 12,0
Max. gradeability without/with vibr.	% 35/30	35/30

Drive

	BOMAG BW 161 ADO - 50	BOMAG BW 202 ADO - 50
Engine manufacturer	Deutz	Deutz
Type	BF4M 2012 C	BF4M 2012 C
Emission stage	2/2	2/2
Cooling	water	water
Number of cylinders	4	4
Performance ISO 14396	kW 103,0	103,0
Speed	min-1 2.500	2.500
Electric equipment	V 12	12

Brakes

	BOMAG BW 161 ADO - 50	BOMAG BW 202 ADO - 50
Service brake	hydrost.	hydrost.
Parking brake	multi disc	multi disc

Steering

	BOMAG BW 161 ADO - 50	BOMAG BW 202 ADO - 50
Steering system	oscil.artic.	oscil.artic.

Exciter system

	BOMAG BW 161 ADO - 50	BOMAG BW 202 ADO - 50
Vibrating drum	front	front
Autom. vibr. shut off	standard	standard
Frequency	Hz 40/55	40/55
Amplitude	mm 0,87/0,44	0,84/0,31
Centrifugal force	kN 95/90	126/88
Oscillating drum	rear	rear
O. Frequency	Hz 40	40
O. Amplitude	mm 1,38	1,37

Capacities

	BOMAG BW 161 ADO - 50	BOMAG BW 202 ADO - 50
Fuel	l 145,0	145,0
Water	l 750,0	750,0

Technical modifications reserved. Machines may be shown with options.



BOMAG
Hellerwald
D-56154 Boppard
P.O. Box 5162
Tel. (0)6742 - 1000
Fax (0)6742 - 3090

