



ECU 14

ECU 16

ECU 18

ECU 20

ECU technical data.

Low lift pallet trucks



This specification sheet to VDI 2198 guidelines states only the technical data for the standard equipment. Different tyres, other masts, additional equipment etc. could result in different values.

Characteristic	STILL		STILL		STILL		STILL		STILL	
	ECU 14		ECU 16		ECU 18		ECU 20		ECU 22	
1.1 Manufacturer	STILL									
1.2 Manufacturer's model designation	Electric									
1.3 Power supply	Electric									
1.4 Operation type: hand, pedestrian, stand-on, sit-on, order picker	Pedestrian									
1.5 Capacity/load	Q	t	1,4	1,6	1,6	1,8	1,8	2,0	2,0	2,0
1.6 Nominal load centre	c	mm	600	600	600	600	600	600	600	600
1.8 Load distance	x	mm	914	914	914	914	914	914	914	914
1.9 Wheelbase	y	mm	1275	1275	1342	1342	1342	1342	1342	1342
2.1 Weight (incl. Battery)	kg		325	432	432	512	512	512	512	512
2.2 Axle loadings laden	kg		591/1134 ¹	723/1309 ²	762/1350 ³	772/1460 ²	808/1503 ³	855/1657 ²	855/1657 ²	855/1657 ²
2.3 Axle loadings unladen	kg		251/74 ¹	336/96 ²	395/117 ²	336/96 ²	395/117 ²	395/117 ²	395/117 ²	395/117 ²
3.1 Tyres (rubber, pneumatic, polyurethane)	Polyurethane									
3.2 Tyre size	mm		230 x 75	230 x 75	230 x 75	230 x 75	230 x 75	230 x 75	230 x 75	230 x 75
3.3 Tyre size	mm		85 x 100	85 x 100	85 x 100	85 x 100	85 x 100	85 x 100	85 x 100	85 x 100
3.4 Castor wheels (size)	mm		ø 100/40	ø 100/40	ø 100/40	ø 100/40	ø 100/40	ø 100/40	ø 100/40	ø 100/40
3.5 Wheels, number (x-drive wheel)	mm		1x - 2/2	1x - 2/2	1x - 2/2	1x - 2/2	1x - 2/2	1x - 2/2	1x - 2/2	1x - 2/2
3.6 Track width	mm		458	458	458	458	458	458	458	458
3.7 Track width	mm		350/390/510	350/390/510	350/390/510	350/390/510	350/390/510	350/390/510	350/390/510	350/390/510
4.4 Lift	mm		123	123	123	123	123	123	123	123
4.9 Height of tiller in drive position	mm		800/1240	800/1240	800/1240	800/1240	800/1240	800/1240	800/1240	800/1240
4.15 Forks height lowered	mm		85	85	85	85	85	85	85	85
4.19 Overall Length	mm		1660	1660	1727	1660	1727	1660	1727	1660
4.20 Length to front face of forks	mm		510	510	577	510	577	510	577	510
4.21 Overall width	mm		720	720	720	720	720	720	720	720
4.22 Forks dimensions	mm		52/170/1150	52/170/1150	52/170/1150	52/170/1150	52/170/1150	52/170/1150	52/170/1150	52/170/1150
4.25 Forks external width	mm		520/560/680	520/560/680	520/560/680	520/560/680	520/560/680	520/560/680	520/560/680	520/560/680
4.32 Floor clearance, centre of wheelbase	mm		36	36	36	36	36	36	36	36
4.33 Working side width for pallets 1000 x 1200 crosswise	mm		1771*	1771*	1838*	1771*	1838*	1771*	1838*	1771*
4.34 Working side width for pallets 800 x 1200 lengthwise (b ₁ x L ₁)	mm		1921*	1921*	2038*	1921*	2038*	1921*	2038*	1921*
4.35 Outer turning radius	mm		1485*	1485*	1552*	1485*	1552*	1485*	1552*	1485*
5.1 Traveling Speed	km/h		5/5	6/6	6/6	6/6	6/6	6/6	6/6	6/6
5.2 Lifting Speed/Time	m/s		0,039/0,047	0,039/0,047	0,039/0,047	0,039/0,047	0,039/0,047	0,039/0,047	0,039/0,047	0,039/0,047
5.3 Lowering Speed/Time	m/s		0,072/0,028	0,087/0,037	0,087/0,037	0,044/0,044	0,044/0,044	0,044/0,044	0,044/0,044	0,044/0,044
5.8 Max. gradeability laden	%		10,0/25,0	8,0/25,0	8,0/25,0	7,3/25,0	7,3/25,0	6,6/25,0	6,6/25,0	6,6/25,0
5.10 Service brakes	Electric									
6.1 Drive motor, rating S2 = 60 min	kW		1,0	1,0	1,0	1,0	1,0	1,0	1,0	1,0
6.2 Lift motor, rating at S3 = 15%	kW		1,0	1,0	1,0	1,0	1,0	1,0	1,0	1,0
6.3 Battery to IEC 254-2, A, B, C, no	British Standard									
6.4 Battery voltage, capacity L ₁	V/Ah		2 x 12/44	24/110 (1150)	DIN 43535 B	24/200 (250)	24/200 (250)	DIN 43535 B	24/200 (250)	DIN 43535 B
6.5 Battery weight ± 5% (dependant on manufacturer)	kg		36,4	123 (152)	150 (220)	123 (152)	150 (220)	123 (152)	150 (220)	150 (220)
8.1 Drive control	Electronic									
8.4 Noise peak at operator's ears	dB (A)		< 70	< 70	< 70	< 70	< 70	< 70	< 70	< 70

* With batteries 12 V/44 Ah
 * With battery 24 V/150 Ah
 * With battery 24 V/250 Ah
 * Value referred to truck with creep speed button ON, and tiller arm rotate of 90°

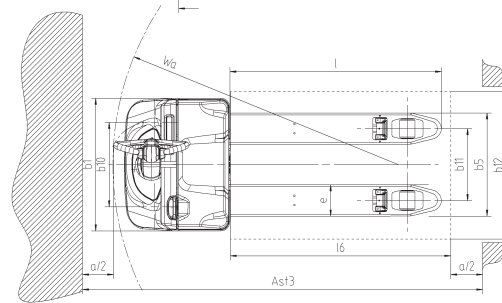
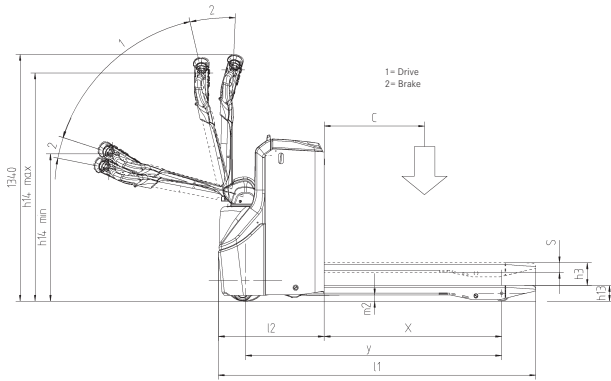

Forks			British Standard battery compartment			DIN Standard battery compartment		
l	e	x	y	z	W	y	l	W
mm	mm	mm	mm	mm	mm	mm	mm	mm
980	500	744	1105	1490	1315	1172	1557	1382
1150	600	914	1275	1680	1485	1342	1727	1552
1450	750	1214	1575	1960	1784	1642	2027	1851
1600	800	1344	1725	2110	1934	1792	2177	2001



Easily operated by both left and right-handed users



Clear display of battery condition and operating hours



Practical layout provides good fork tips visibility



The ECU is right at home transporting goods horizontally for industry, trade and commerce



Simply practical.

ECU low lift pallet trucks have a load capacity of 1400–2000 kg and are dependable companions for transporting goods horizontally. As the entry-level equipment for light tasks, the ECU 14 offers a built-in maintenance-free gel battery and an integrated charger.

Construction.

- The compact battery compartment comprises one continuous plate so provides optimal protection for the batteries.
- The robust bodywork is constructed from heavy duty polyurethane that is able to withstand impacts without permanent deformation or breakage.

Tiller.

- The shape of the tiller together with its ergonomic grip and buttons facilitates easy operation by both right-handed and left-handed users.
- The tiller's shape is designed to ensure the best possible operating position in even the tightest spaces.
- The new tiller greatly reduces operator fatigue. When released the tiller will reposition itself to its vertical position.
- The impact switch on the tiller head prevents operators becoming trapped. Should the operator touch the impact switch the ECU will automatically switch from forward to reverse.

Drive.

- The 1KW three-phase drive gives even power output whether the equipment is laden or empty.
The maintenance-free AC technology contributes to low energy and maintenance costs.
- RF control on all models.
- The control system enables energy to be recovered when the drive switch is released and during regenerative braking.
- The ECU has an hour meter with discharge indicator fitted as standard.

Brakes.

- The ECU has two different braking systems:
- A reverse current brake
 - An electromagnetic emergency brake controlled by a micro switch actuated at the two tiller end positions.

Battery.

- Two different battery trays allow batteries of capacities from 24V/150Ah to 24V/250Ah to be accommodated.
- The batteries are easily accessible.
- The ECU 14 has two maintenance-free 12V/44Ah gel batteries.

Load rollers.

- Single polyurethane rollers are fitted as standard.
- Tandem rollers are optionally available.

Drive wheel.

- Polyurethane is provided as standard for long service life.
- A solid rubber drive wheel is optionally available.

Fork dimensions.

- Fork lengths are 980 mm, 1150 mm, 1450 mm, and 1600 mm.
- Fork widths are 520 mm, 560 mm, and 680 mm.

Maintenance.

- Two lifting points are mounted on the frame to enable the equipment to be safely raised by crane hooks.
- All parameters relating to the drive, electrical braking system, and electrical functions are configurable and can be modified in accordance with customer-specific individual requirements through STILL Customer Services.

Options.

- Access control via PIN code entry.
- Creep speed mode for manoeuvring in tight spaces.
- Integrated on-board charger.



Your contact

STILL GmbH
Berzeliusstraße 10
D-22113 Hamburg
Telephone: +49 (0)40/73 39-2000
Telefax: +49 (0)40/73 39-2001
info@still.de

For further information please visit:
www.still.de

STILL Materials Handling Ltd.
Aston Way, Leyland
Lancashire PR26 7UX
Telephone: +44 (0)1772 644300
Telefax: +44 (0)1772 644303
info@still.co.uk

For further information please visit:
www.still.co.uk